

DOLCE II *Bathroom Accessories*

Version : 202507

Color Options



Chrome



Gun Metal



Brushed Nickel



Matte Black



Brushed Gold

DOLCE II BATHROOM ACCESSORIES

ROBE HOOK

NR2082CH/NR2082MB/NR2082BN
NR2082GM/NR2082BG

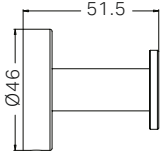

TOILET ROLL HOLDER

NR2086CH/NR2086MB/NR2086BN
NR2086GM/NR2086BG

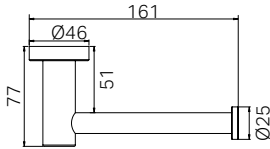

TOILET ROLL HOLDER

NR2080CH/NR2080MB/NR2080BN
NR2080GM/NR2080BG

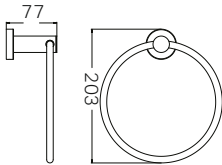

METAL SHOWER SHELF

NR2087aCH/NR2087aMB/NR2087aBN
NR2087aGM/NR2087aBG

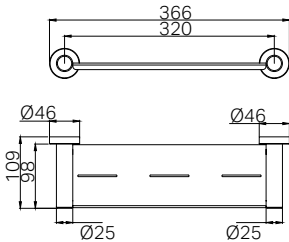

SINGLE TOWEL RAIL 600MM

NR2024CH/NR2024MB/NR2024BN
NR2024GM/NR2024BG

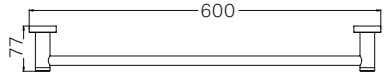

DOUBLE TOWEL RAIL 600MM

NR2024dCH/NR2024dMB/NR2024dBN
NR2024dGM/NR2024dBG

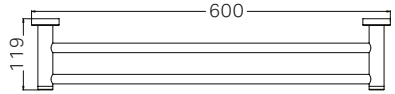

SINGLE TOWEL RAIL 800MM

NR2030CH/NR2030MB/NR2030BN
NR2030GM/NR2030BG

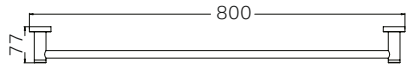

DOUBLE TOWEL RAIL 800MM

NR2030dCH/NR2030dMB/NR2030dBN
NR2030dGM/NR2030dBG

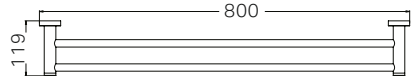

GENERAL INSTALLATION INSTRUCTIONS

The following instructions provide general installation guidelines for Dolce II bathroom accessories. Specific steps may vary depending on the product configuration and model.

Please ensure installation is carried out by a suitably qualified tradesperson.

Prior to drilling, verify that there are no concealed services (e.g. water pipes, electrical wiring) behind the selected installation area.)

Do not substitute mechanical fixings with adhesive or silicone-based products.

Avoid installing the product on surfaces subject to constant vibration, movement, or structural instability.

MAINTENANCE AND CARE

Periodically inspect the fittings to ensure they remain secure. Re-tighten fixings as required.

Use a soft cloth and mild soapy water to clean the surface. Do not use harsh chemicals, abrasive cleaners, acidic substances, or scouring pads, as these may damage the finish.

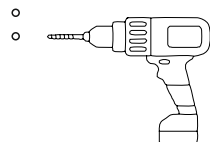
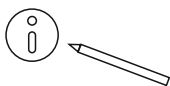

1. Mark the mounting holes

Position the mounting bracket against the wall at the desired location.
Mark the centre of each mounting hole.

2. Drill the mounting holes

Using a 6mm drill bit, drill into the marked positions to an appropriate depth for the supplied wall plugs.

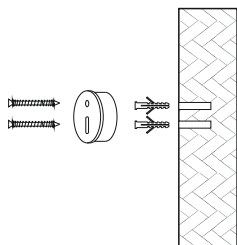

3. Fix the mounting bracket

Insert the wall plugs flush into the holes, align the bracket, and secure it with the supplied screws.

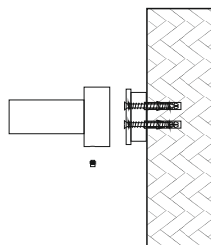

4. Attach the Accessory

Place the accessory body over the mounting bracket. Secure in position by tightening the grub screw with the Allen key provided.

Note: Use suitable wall anchors for hollow or cavity walls to ensure load-bearing strength.

Confirm that the accessory is firmly fixed and does not wobble.

Nero

