

Dolce II Rail Shower

Nero

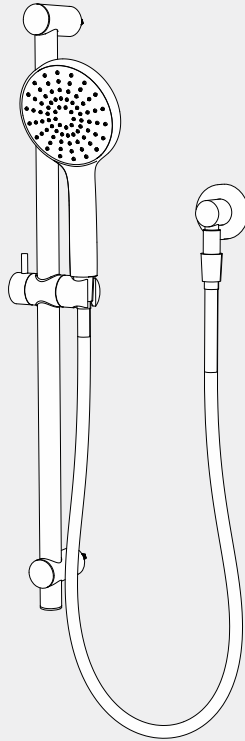

Version : 202508a



Drawing

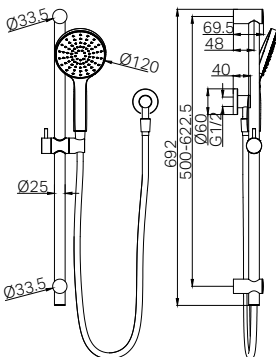

Specifications

Watermark License

WM-060093

Temperature Rating

Min 1°C–Max75°C

Pressure Rating

Min 150kpa - Max 500kpa

Package Includes

- 1 x Hand Shower
- 1 x Shower Rail
- 1 x Elbow
- (Built-in Dual-Check Valve)
- 1 x 1.5m Shower Hose

Finish & SKU

 **Chrome**
NR322CH

 **Matte Black**
NR322MB

 **Gun Metal**
NR322GM

 **Brushed Gold**
NR322BG

 **Brushed Nickel**
NR322BN

*Dimensions are nominal measurements only.

INSTALLATION INSTRUCTIONS

GENERAL INSTRUCTIONS:

- This product must be installed by a licensed plumber. Ensure that your plumbing installation complies with the Australian/New Zealand Standard AS/NZS 3500.
- All pipework must be thoroughly flushed prior to the installation of the mixer. In-line filters must be fitted on both hot and cold supplies to prevent foreign particles from damaging the ceramic cartridge.
- Ensure that all outlets used for personal hygiene deliver water at a safe temperature in accordance with regional regulations.
- Verify that the water pressure is within the recommended range for the shower to function properly.

PARTS NAME

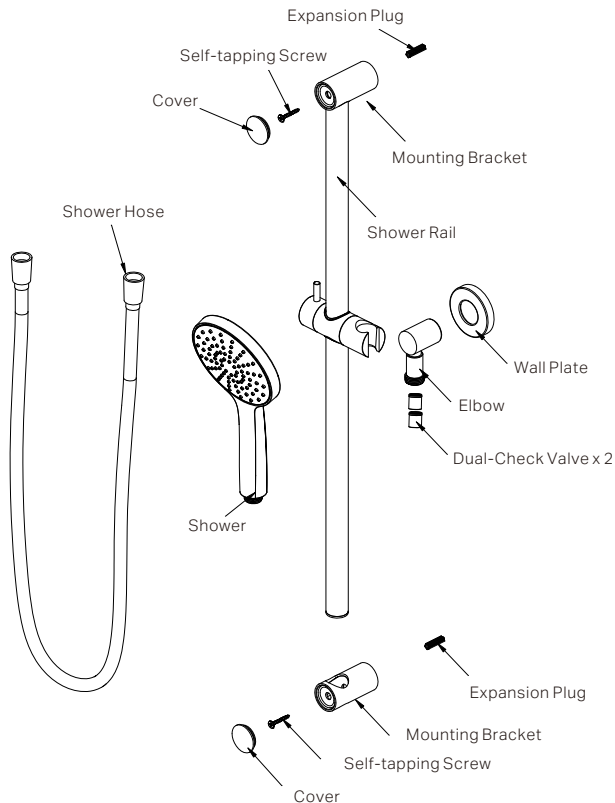

INSTALLATION STEPS

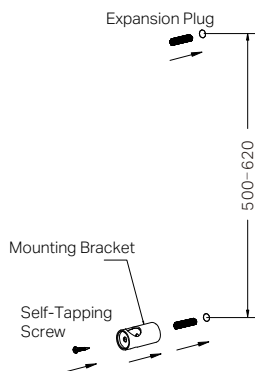
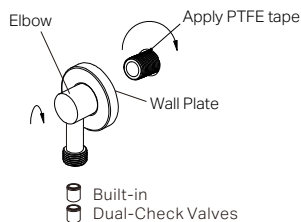

01. Apply PTFE tape to the outlet thread.
02. Slide the wall plate to the elbow and screw the elbow onto the outlet thread.

03. Drill two $\varnothing 6$ mm mounting holes on the same vertical line, 500–620mm apart, push the expansion plugs into mounting holes.
04. Secure the bottom mounting bracket to the wall with self-tapping screw.

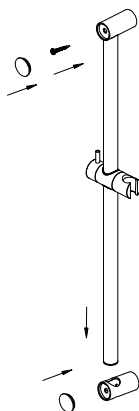

05. Insert the rail into two mounting brackets. Secure the upper mounting bracket and rail to the expansion plug using self-tapping screw. Press the covers onto the upper and lower mounting brackets respectively.

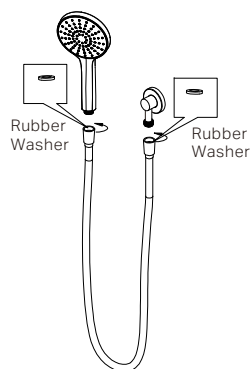

06. Connect the hand shower to the elbow using the provided shower hose. Note: Ensure rubber washers are in place at both ends of the shower hose to prevent leaks.

FINAL INSPECTION

Switch on the water supply and check for any leakage at the joints.

Nero

